

CERTIFIED RECORD OF LAND CORNER MONUMENTATION

USDA-FOREST SERVICE

Index File No. B-15

CORNER RECORD (SEARCH)
(Ref. FSM 7151.4)

Tract or Survey No. _____ Cor. CN
No. 1/16

T 16 S R. 34 E R.D. Prairie City County Grant
Merid. Willamette N.F. Malheur State Or.

CORNER DIAGRAM

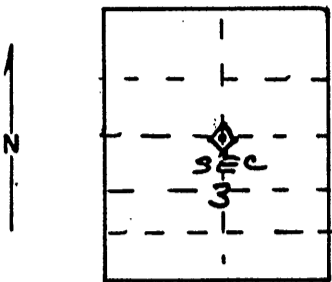

DESCRIBE CORNER MONUMENT FOUND

NO ORIG. GLO

DESCRIBE BEARING TREES OR OTHER OFFICIAL ACCESSORIES FOUND

NONE

PHOTO IDENTIFICATION DATA

Photo No. _____
Filed At _____

CORNER RECORD (PERPETUATION)

MONUMENT: DESCRIBE NEW MONUMENT SET, OR WORK DONE TO PRESERVE EXISTING MONUMENT

2 1/2" X 30" Alum. pipe with alum cap set 21" in ground in small stone mound. cap stamped as shown. *IN VERY WET BOGGY AREA.*

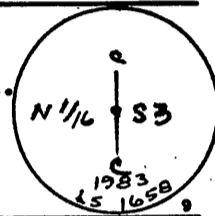

ACCESSORIES: DESCRIBE NEW BT'S WITNESS OBJECTS ETC. ESTABLISHED, OR WORK DONE TO PRESERVE EXISTING EVIDENCE

14" L.P., N40 1/2°W, 190.6' to face, 191.3' to CL, marked "CN 1/16 S3 BT"
12" L.P., S41 1/2°W, 87.4' to face, 88.0' to CL, marked. "CN 1/16 S3 BT"
Steel fence posts w. signs set 5' North and 5' East.
B.T.'s signed and painted. Magnetic Variation- 17°E

Work Done By. R.H. Schulson Title Land Surveyor Date 8-83 State Registration No. #1658
or Agency _____

Certified Cor. Record Prepared? Yes _____ No Filed At: _____ Date _____

REMARKS

Witnessed by: Randall Schulson

Index File No. B-15 T. 16S R. 34E M. Tract or Surv. No. _____ Cor. CN 1/16

SEP 16 1983

**REGISTERED
PROFESSIONAL
LAND SURVEYOR**

Ronald H. Schulson

OREGON
JULY 14, 1978
RONALD H. SCHULSON
1658

Office of..... County Surveyor County of..... Grant
State of..... Oregon I hereby certify that the within instrument was filed in this office
for record on the 30 day of..... Nov , 1983.
Robert D. Bayliff by _____
(COUNTY OFFICIAL) (DEPUTY)

B-15